

Line-No.	Date	27.02.2012	Order-No.		Amount		Supplier Laserpack Fryazino Die-Side
	Path	aserpack/filesW	Author	Yashin A	Height		
	File	b> ECMA_A2420.d	Customer		Manufacturer		
	10/15/18		Line type		Material		
	Sonstiges		Pointage		Mat. Table		

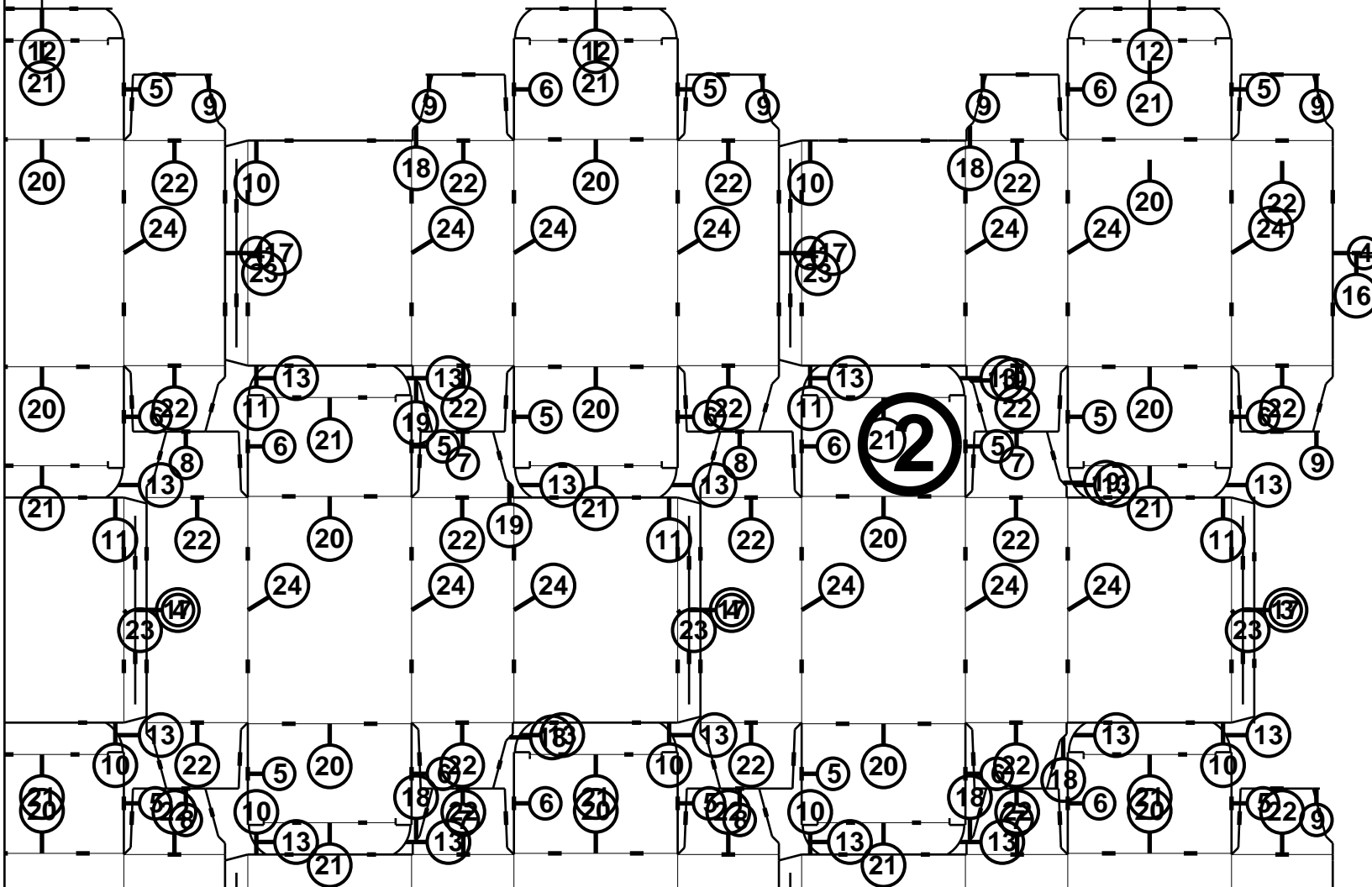

Line-No.	Date	27.02.2012	Order-No.		Amount		Supplier Laserpack Fryazino
	Path	aserpack/filesW	Author	Yashin A	Height		
	File	b> ECMA_A2420.d	Customer		Manufacturer		
	10/15/18		Line type		Material		
	Sonstiges		Pointage		Mat. Table		

Rule Processing System ACS 100 for ISO 9000

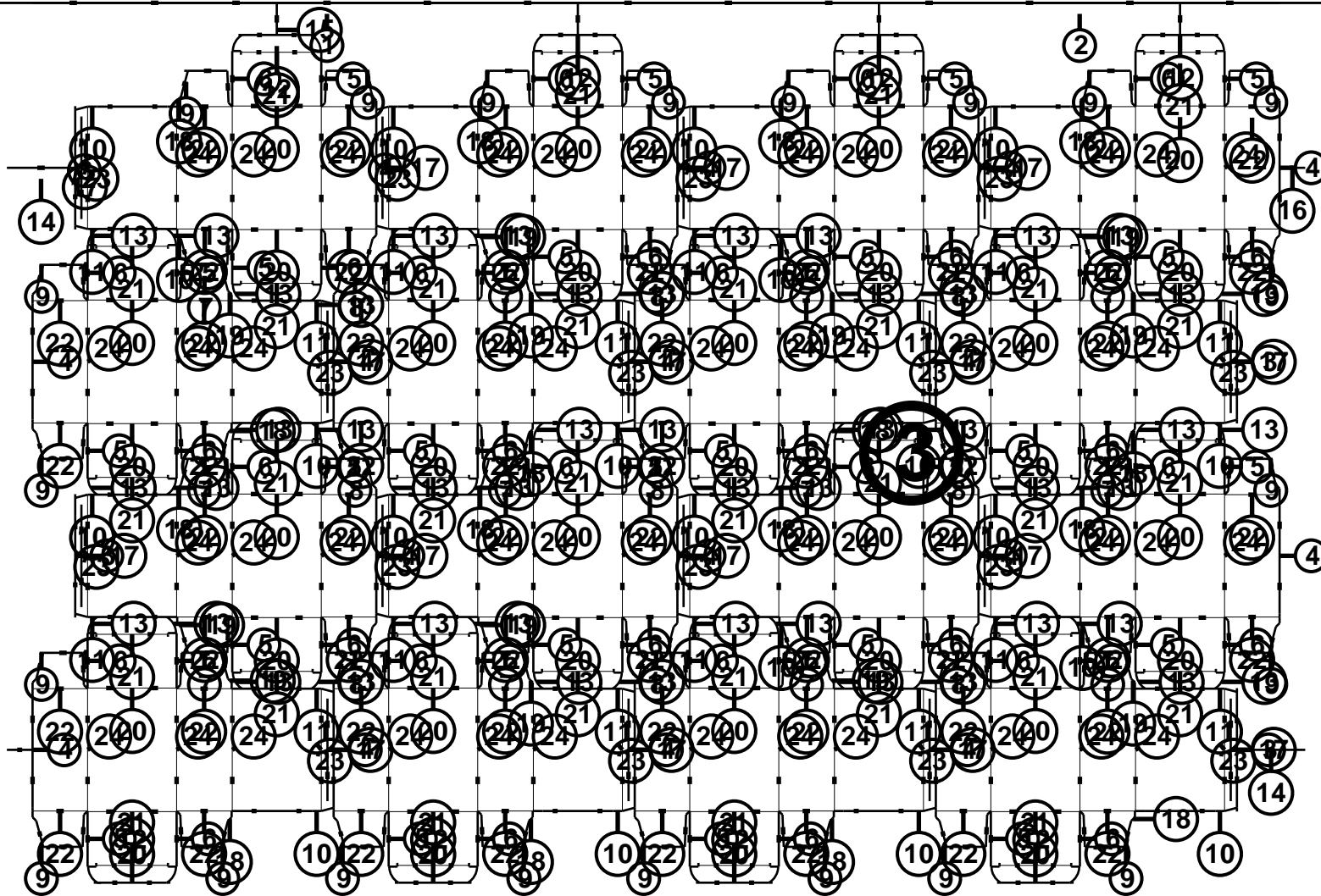

Line-No.	Date	27.02.2012	Order-No.		Amount		Supplier Laserpack Fryazino
	Path	aserpack/filesW	Author	Yashin A	Height		
	File	b> ECMA_A2420.d	Customer		Manufacturer		
	10/15/18		Line type		Material		
	Sonstiges		Pointage		Mat. Table		

Rule Processing System ACS 100 for ISO 9000

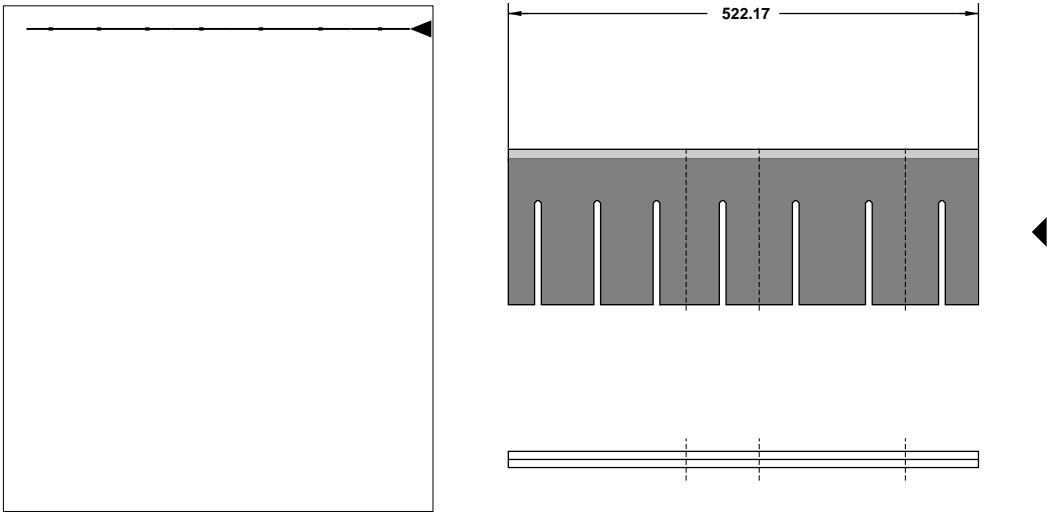

Line-No.	Date	27.02.2012	Order-No.		Amount	1	Supplier	
1	Path	aserpack/filesW	Author	Yashin A	Height	23.80	Laserpack Fryazino	
	File	b> ECMA_A2420.d	Customer		Manufacturer	Boehler		
	10/15/18		Line type	Cut	Material	UNIVERSAL-T30		
	Sonstiges		Pointage	2.00	Mat. Table	04		Die-Side

Rule Processing System ACS 100 for ISO 9000

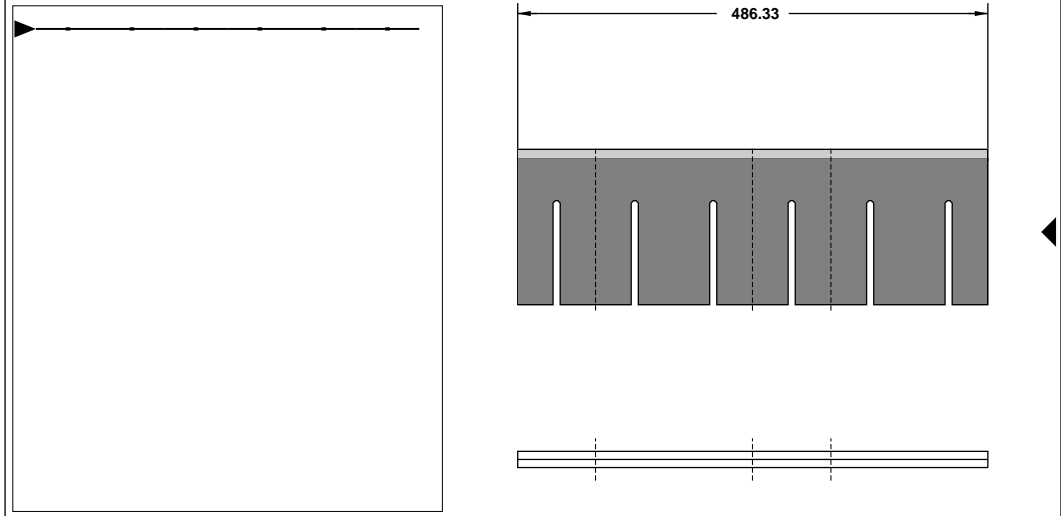

Line-No.	Date	27.02.2012	Order-No.		Amount	1	Supplier	
2	Path	aserpack/filesW	Author	Yashin A	Height	23.80	Laserpack Fryazino	
	File	b> ECMA_A2420.d	Customer		Manufacturer	Boehler		
	10/15/18		Line type	Cut	Material	UNIVERSAL-T30		
	Sonstiges		Pointage	2.00	Mat. Table	04		Die-Side

Rule Processing System ACS 100 for ISO 9000

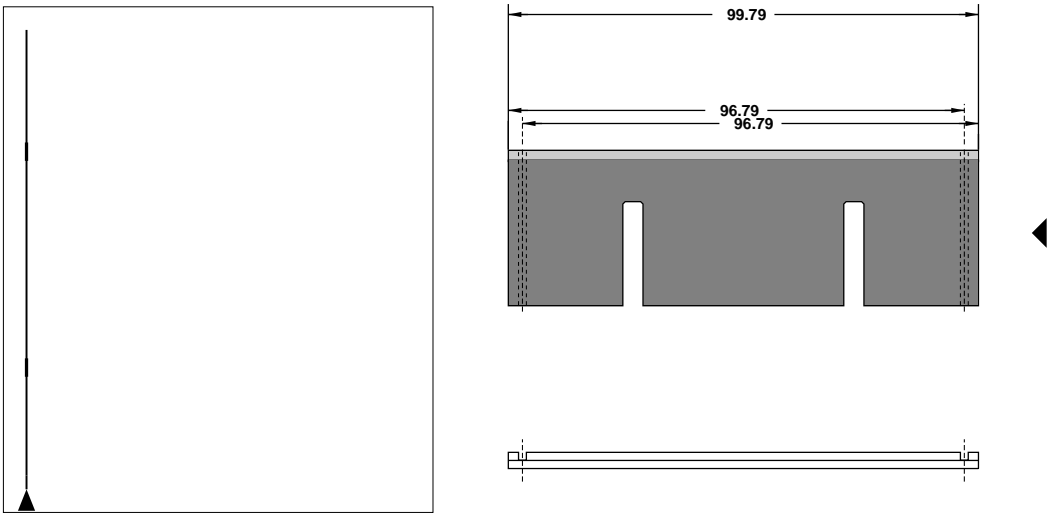

Line-No.	Date	27.02.2012	Order-No.		Amount	4	Supplier	
3	Path	aserpack/filesW	Author	Yashin A	Height	23.80	Laserpack Fryazino	
	File	b> ECMA_A2420.d	Customer		Manufacturer	Boehler		
	10/15/18		Line type	Cut	Material	UNIVERSAL-T30		
	Sonstiges		Pointage	2.00	Mat. Table	04		Die-Side

Rule Processing System ACS 100 for ISO 9000

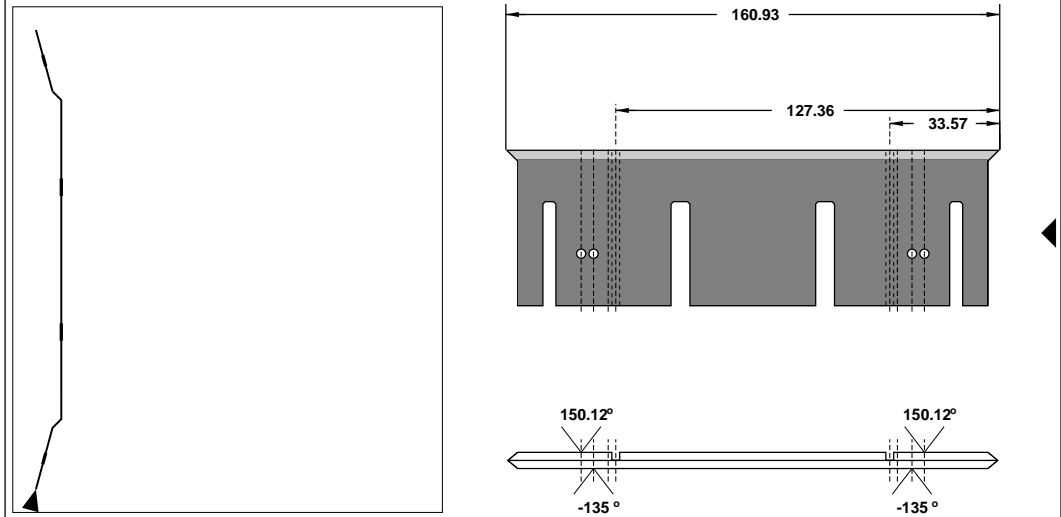

Line-No.	Date	27.02.2012	Order-No.		Amount	16	Supplier	
4	Path	aserpack/filesW	Author	Yashin A	Height	23.80	Laserpack Fryazino	
	File	b> ECMA_A2420.d	Customer		Manufacturer	Boehler		
	10/15/18		Line type	Cut	Material	UNIVERSAL-T30		
	Sonstiges		Pointage	2.00	Mat. Table	04		Die-Side

Rule Processing System ACS 100 for ISO 9000

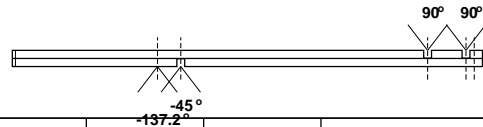
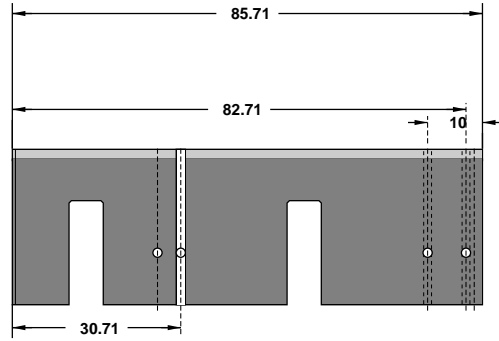
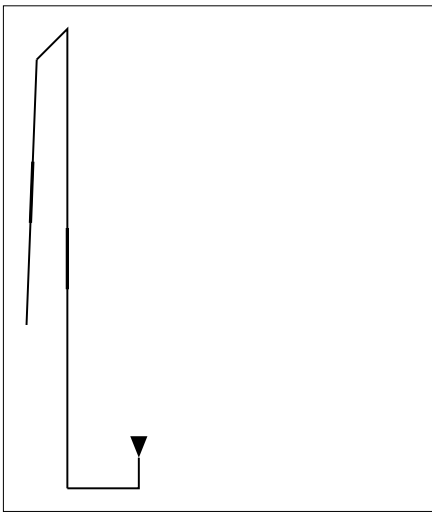

5	Line-No.	Date	27.02.2012	Order-No.		Amount	32	Supplier	
	Path	asERPack/filesW	Author	Yashin A	Height	23.80		Laserpack Fryazino	
	File	b> ECMA_A2420.d	Customer		Manufacturer	Boehler			
	10/15/18		Line type	PERFO	Material	UNIVERSAL-T30			
	Sonstiges		Pointage	2.00	Mat. Table	04	Die-Side		

Rule Processing System ACS 100 for ISO 9000

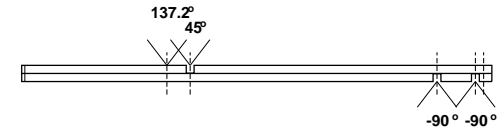
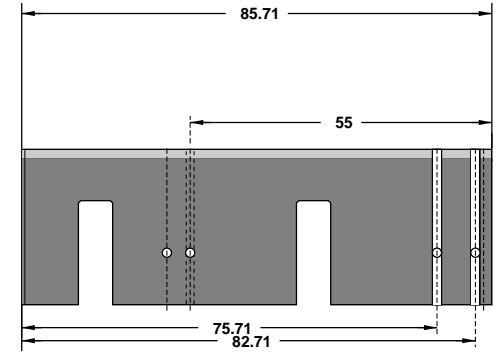
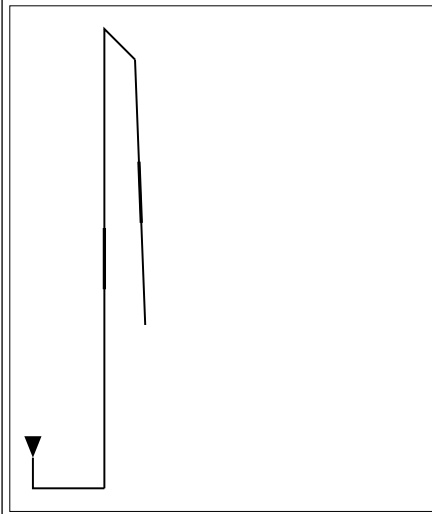

6	Line-No.	Date	27.02.2012	Order-No.		Amount	32	Supplier	
	Path	asERPack/filesW	Author	Yashin A	Height	23.80		Laserpack Fryazino	
	File	b> ECMA_A2420.d	Customer		Manufacturer	Boehler			
	10/15/18		Line type	PERFO	Material	UNIVERSAL-T30			
	Sonstiges		Pointage	2.00	Mat. Table	04	Die-Side		

Rule Processing System ACS 100 for ISO 9000

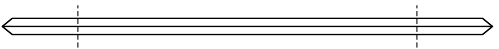
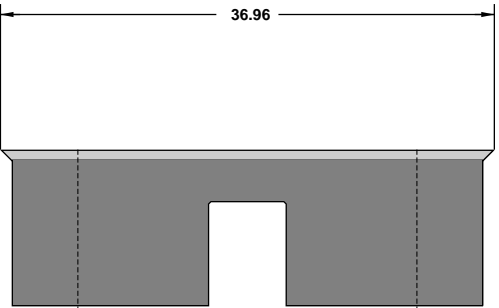
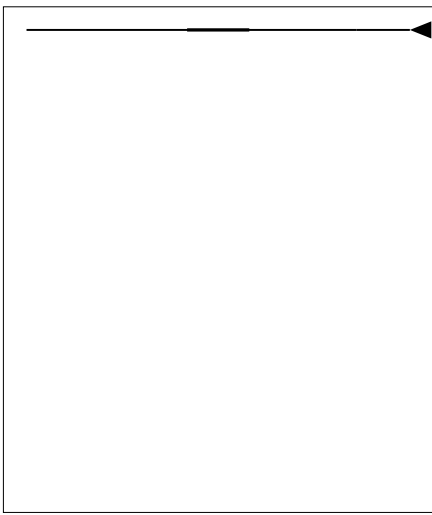

7	Line-No.	Date	27.02.2012	Order-No.		Amount	12	Supplier	
	Path	asERPack/filesW	Author	Yashin A	Height	23.80		Laserpack Fryazino	
	File	b> ECMA_A2420.d	Customer		Manufacturer	Boehler			
	10/15/18		Line type	Cut	Material	UNIVERSAL-T30			
	Sonstiges		Pointage	2.00	Mat. Table	04	Die-Side		

Rule Processing System ACS 100 for ISO 9000

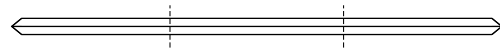
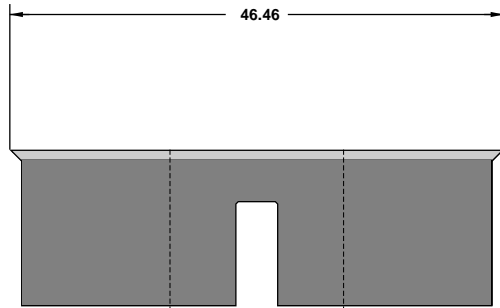
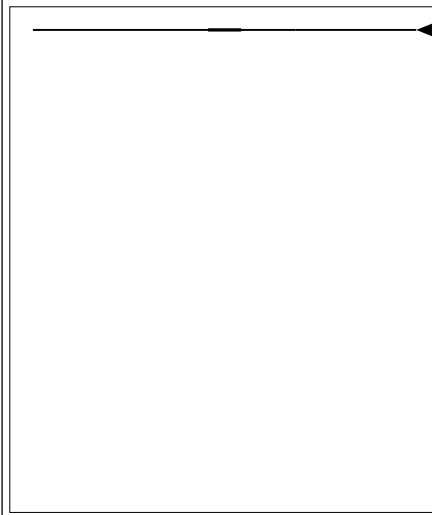

8	Line-No.	Date	27.02.2012	Order-No.		Amount	9	Supplier	
	Path	asERPack/filesW	Author	Yashin A	Height	23.80		Laserpack Fryazino	
	File	b> ECMA_A2420.d	Customer		Manufacturer	Boehler			
	10/15/18		Line type	Cut	Material	UNIVERSAL-T30			
	Sonstiges		Pointage	2.00	Mat. Table	04	Die-Side		

Rule Processing System ACS 100 for ISO 9000

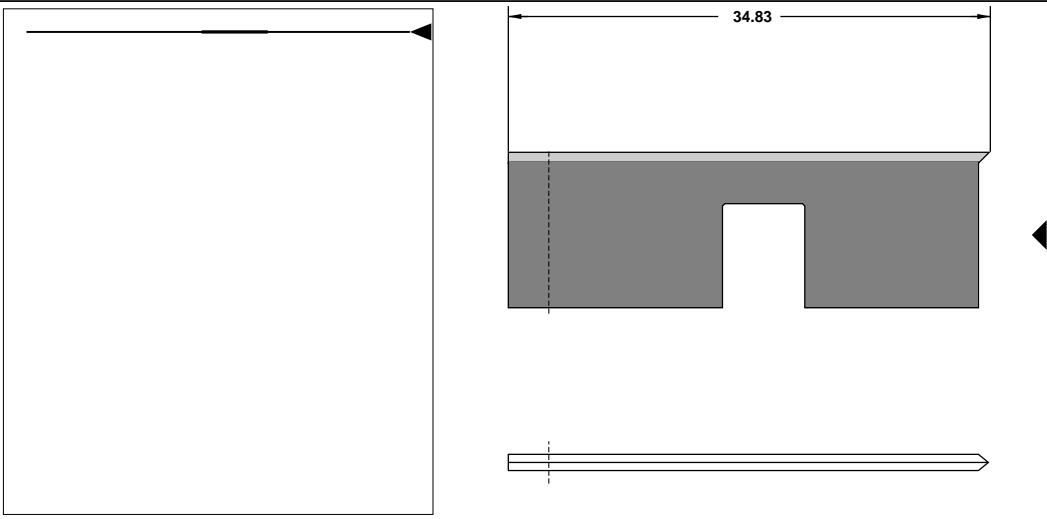

9	Line-No.	Date	27.02.2012	Order-No.		Amount	22	Supplier	
	Path	asercpack/filesW	Author	Yashin A	Height	23.80	Laserpack Fryazino		
	File	b> ECMA_A2420.doc	Customer		Manufacturer	Boehler			
	10/15/18		Line type	Cut	Material	UNIVERSAL-T30			
	Sonstiges		Pointage	2.00	Mat. Table	04	Die-Side		

Rule Processing System ACS 100 for ISO 9000

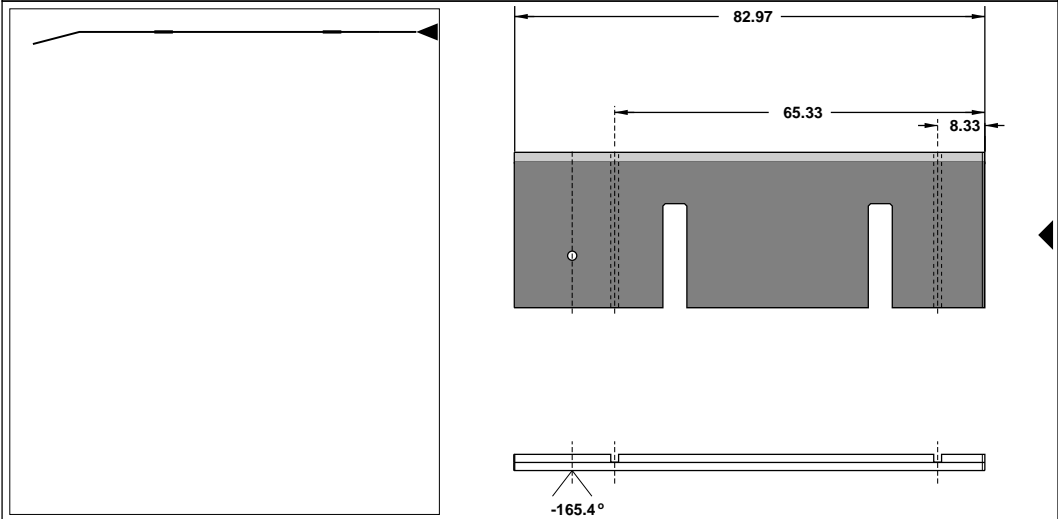

10	Line-No.	Date	27.02.2012	Order-No.		Amount	16	Supplier	
	Path	asercpack/filesW	Author	Yashin A	Height	23.20	Laserpack Fryazino		
	File	b> ECMA_A2420.doc	Customer		Manufacturer	Boehler			
	10/15/18		Line type	Cut	Material	UNIVERSAL-T30			
	Sonstiges		Pointage	2.00	Mat. Table	04	Die-Side		

Rule Processing System ACS 100 for ISO 9000

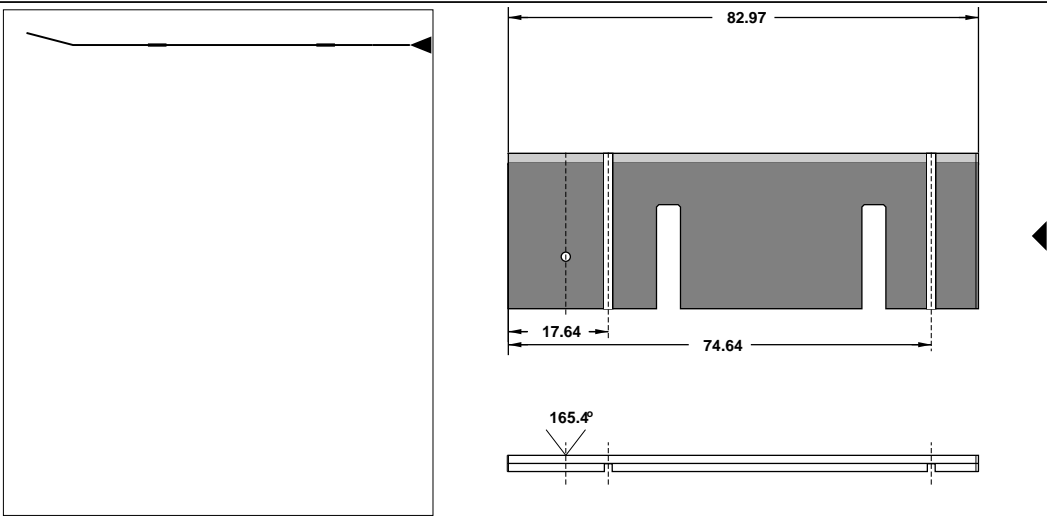

11	Line-No.	Date	27.02.2012	Order-No.		Amount	16	Supplier	
	Path	asercpack/filesW	Author	Yashin A	Height	23.20	Laserpack Fryazino		
	File	b> ECMA_A2420.doc	Customer		Manufacturer	Boehler			
	10/15/18		Line type	Cut	Material	UNIVERSAL-T30			
	Sonstiges		Pointage	2.00	Mat. Table	04	Die-Side		

Rule Processing System ACS 100 for ISO 9000

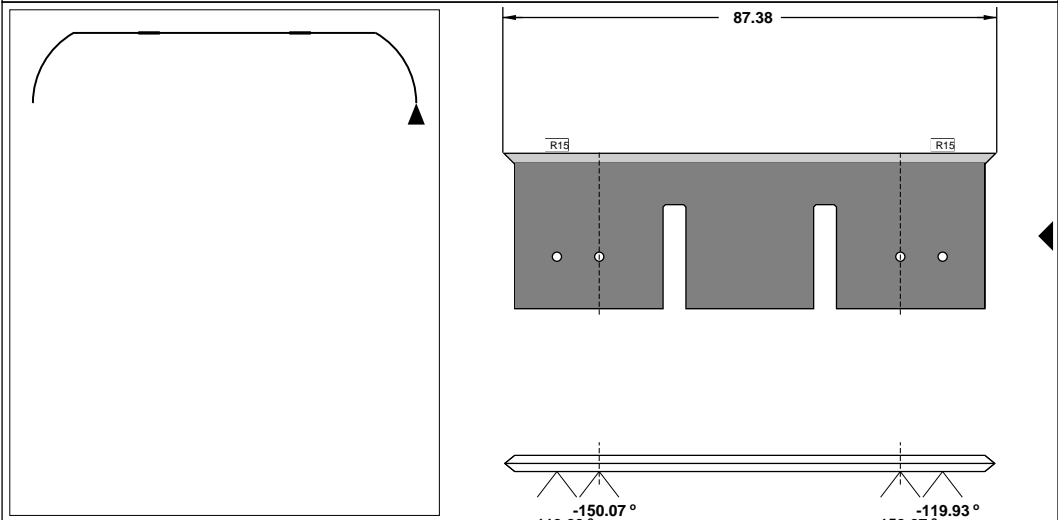

12	Line-No.	Date	27.02.2012	Order-No.		Amount	8	Supplier	
	Path	asercpack/filesW	Author	Yashin A	Height	23.80	Laserpack Fryazino		
	File	b> ECMA_A2420.doc	Customer		Manufacturer	Boehler			
	10/15/18		Line type	Cut	Material	UNIVERSAL-T30			
	Sonstiges		Pointage	2.00	Mat. Table	04	Die-Side		

Rule Processing System ACS 100 for ISO 9000

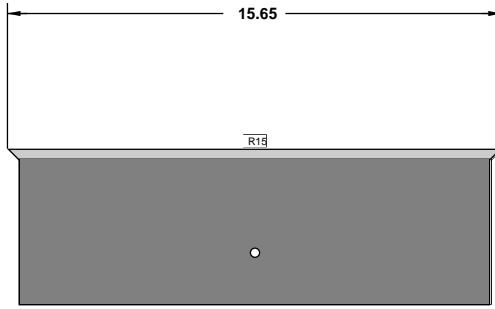
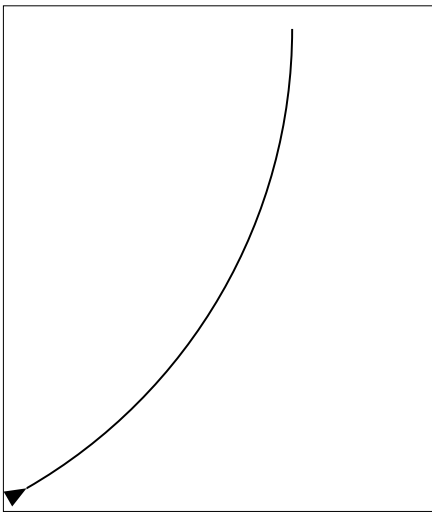

Line-No.	Date	27.02.2012	Order-No.		Amount	48	Supplier
13	Path	aserpack/filesW	Author	Yashin A	Height	23.80	Laserpack Fryazino
	File	b> ECMA_A2420.d	Customer		Manufacturer	Boehler	
	10/15/18		Line type	Cut	Material	UNIVERSAL-T30	
	Sonstiges		Pointage	2.00	Mat. Table	04	
					Die-Side		

Rule Processing System ACS 100 for ISO 9000

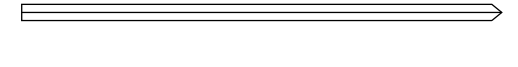
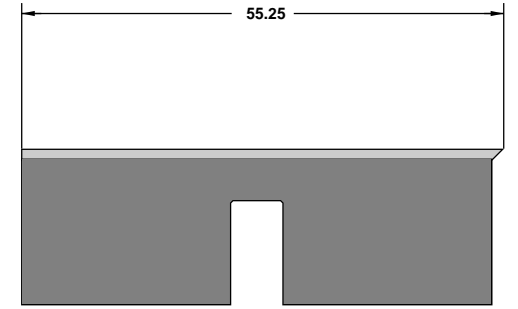
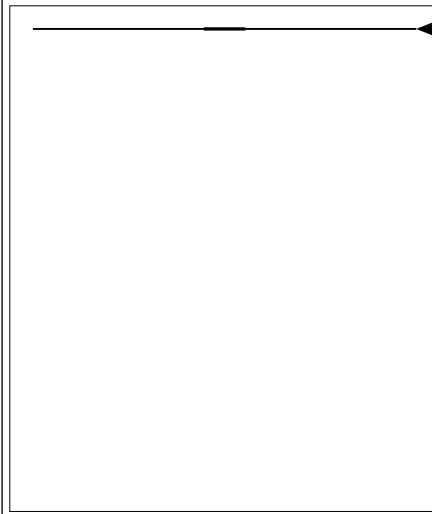

Line-No.	Date	27.02.2012	Order-No.		Amount	2	Supplier
14	Path	aserpack/filesW	Author	Yashin A	Height	23.80	Laserpack Fryazino
	File	b> ECMA_A2420.d	Customer		Manufacturer	Boehler	
	10/15/18		Line type	Cut	Material	UNIVERSAL-T30	
	Sonstiges		Pointage	2.00	Mat. Table	04	
					Die-Side		

Rule Processing System ACS 100 for ISO 9000

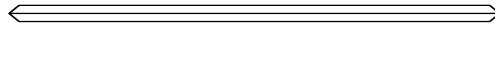
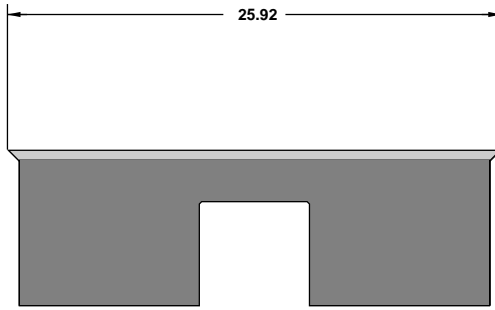
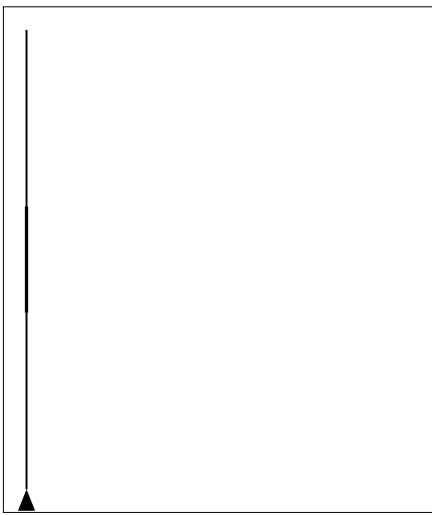

Line-No.	Date	27.02.2012	Order-No.		Amount	4	Supplier
15	Path	aserpack/filesW	Author	Yashin A	Height	23.80	Laserpack Fryazino
	File	b> ECMA_A2420.d	Customer		Manufacturer	Boehler	
	10/15/18		Line type	Cut	Material	UNIVERSAL-T30	
	Sonstiges		Pointage	2.00	Mat. Table	04	
					Die-Side		

Rule Processing System ACS 100 for ISO 9000

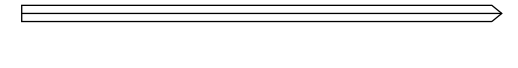
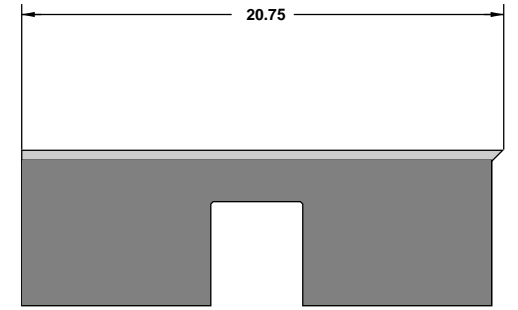

Line-No.	Date	27.02.2012	Order-No.		Amount	2	Supplier
16	Path	aserpack/filesW	Author	Yashin A	Height	23.80	Laserpack Fryazino
	File	b> ECMA_A2420.d	Customer		Manufacturer	Boehler	
	10/15/18		Line type	Cut	Material	UNIVERSAL-T30	
	Sonstiges		Pointage	2.00	Mat. Table	04	
					Die-Side		

Rule Processing System ACS 100 for ISO 9000

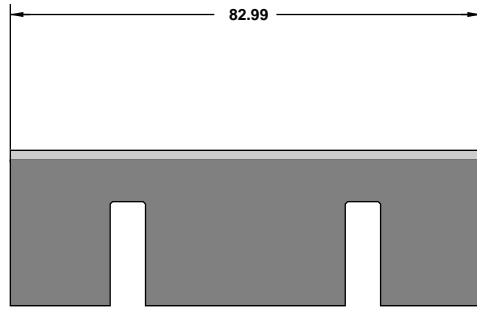
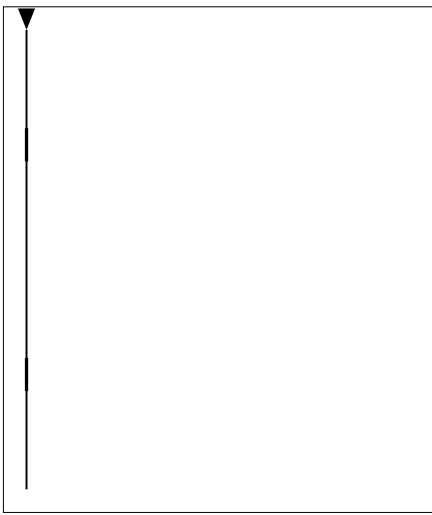

PERFO KLEEVAY

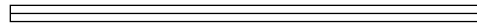

17	Line-No.	Date	27.02.2012	Order-No.		Amount	16	Supplier	
	Path	aserpack/filesW	Author	Yashin A	Height	23.80	Laserpack Fryazino		
	File	b> ECMA_A2420.doc	Customer		Manufacturer	Boehler			
	10/15/18		Line type	PERFO	Material	UNIVERSAL-T30			
	Sonstiges		Pointage	2.00	Mat. Table	04	Die-Side		

Rule Processing System ACS 100 for ISO 9000

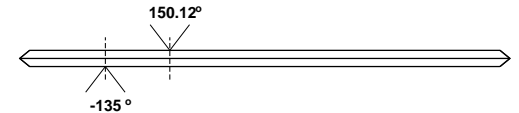
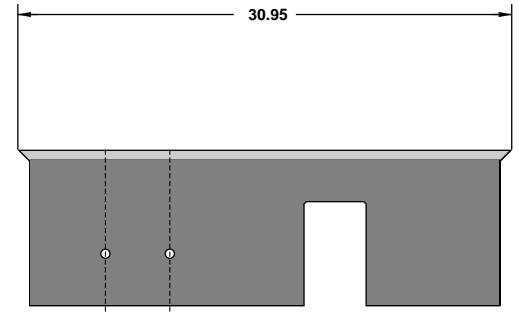
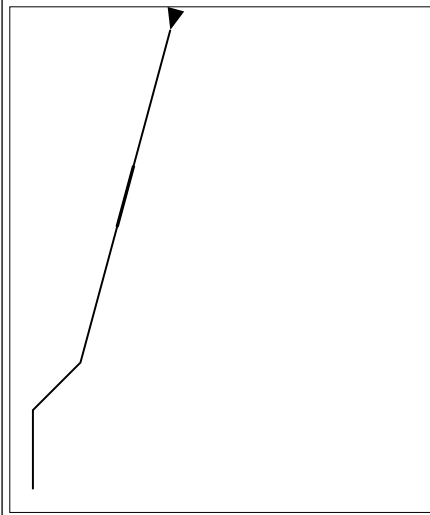

18	Line-No.	Date	27.02.2012	Order-No.		Amount	16	Supplier	
	Path	aserpack/filesW	Author	Yashin A	Height	23.80	Laserpack Fryazino		
	File	b> ECMA_A2420.doc	Customer		Manufacturer	Boehler			
	10/15/18		Line type	Cut	Material	UNIVERSAL-T30			
	Sonstiges		Pointage	2.00	Mat. Table	04	Die-Side		

Rule Processing System ACS 100 for ISO 9000

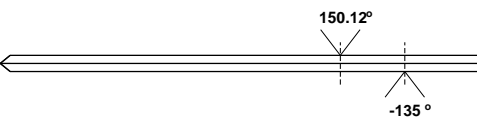
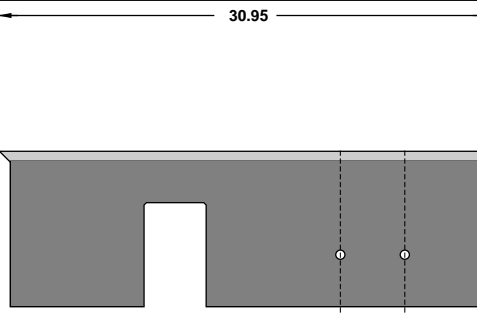
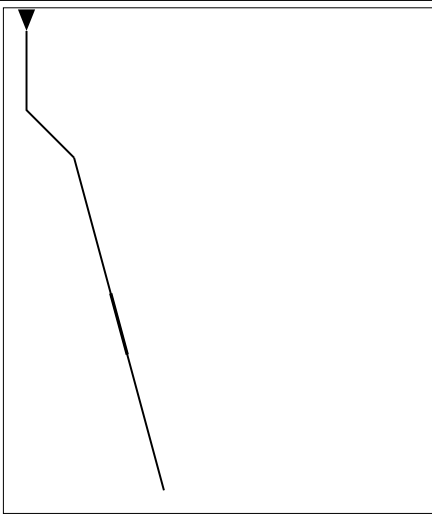

19	Line-No.	Date	27.02.2012	Order-No.		Amount	16	Supplier	
	Path	aserpack/filesW	Author	Yashin A	Height	23.80	Laserpack Fryazino		
	File	b> ECMA_A2420.doc	Customer		Manufacturer	Boehler			
	10/15/18		Line type	Cut	Material	UNIVERSAL-T30			
	Sonstiges		Pointage	2.00	Mat. Table	04	Die-Side		

Rule Processing System ACS 100 for ISO 9000

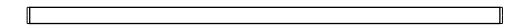
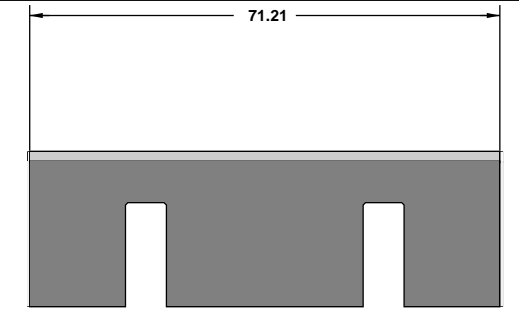
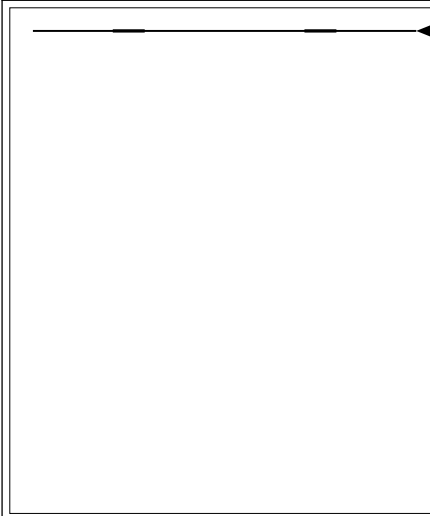

20	Line-No.	Date	27.02.2012	Order-No.		Amount	32	Supplier	
	Path	aserpack/filesW	Author	Yashin A	Height	23.30	Laserpack Fryazino		
	File	b> ECMA_A2420.doc	Customer		Manufacturer	Boehler			
	10/15/18		Line type	Crease	Material	UNIVERSAL-T30			
	Sonstiges		Pointage	2.00	Mat. Table	04	Die-Side		

Rule Processing System ACS 100 for ISO 9000

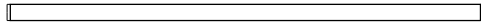
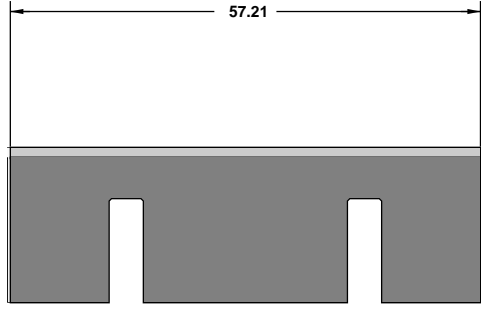
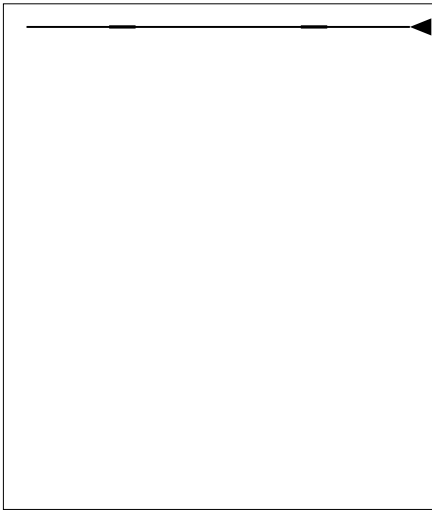

21	Line-No.		Date	27.02.2012	Order-No.		Amount	32	Supplier	
	Path	aserpack/filesW	Author	Yashin A	Height	23.30	Laserpack Fryazino			
	File	b> ECMA_A2420.doc	Customer		Manufacturer	Boehler				
	10/15/18		Line type	Crease	Material	UNIVERSAL-T30				
	Sonstiges		Pointage	2.00	Mat. Table	04	Die-Side			

Rule Processing System ACS 100 for ISO 9000

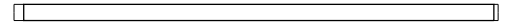
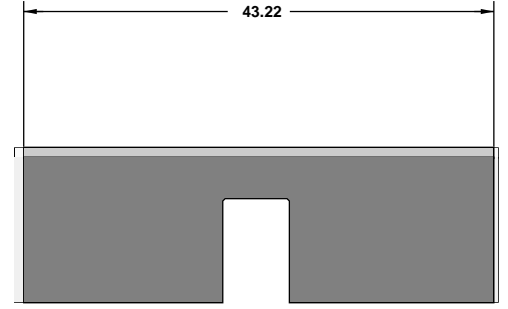
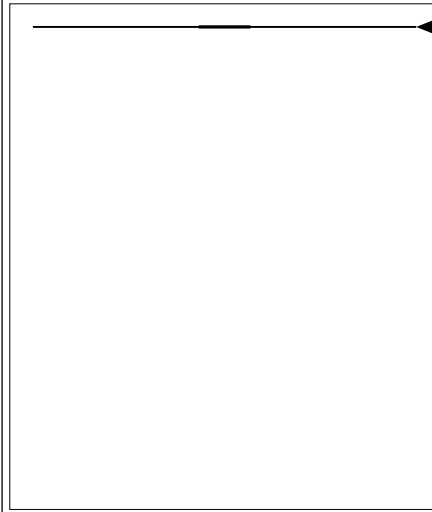

22	Line-No.		Date	27.02.2012	Order-No.		Amount	64	Supplier	
	Path	aserpack/filesW	Author	Yashin A	Height	23.30	Laserpack Fryazino			
	File	b> ECMA_A2420.doc	Customer		Manufacturer	Boehler				
	10/15/18		Line type	Crease	Material	UNIVERSAL-T30				
	Sonstiges		Pointage	2.00	Mat. Table	04	Die-Side			

Rule Processing System ACS 100 for ISO 9000

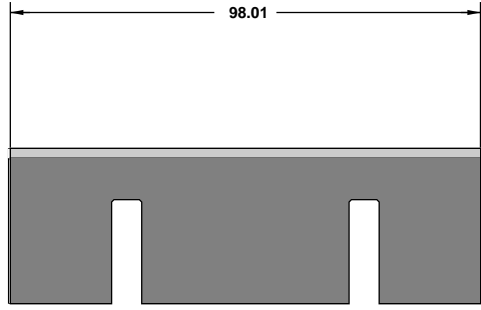
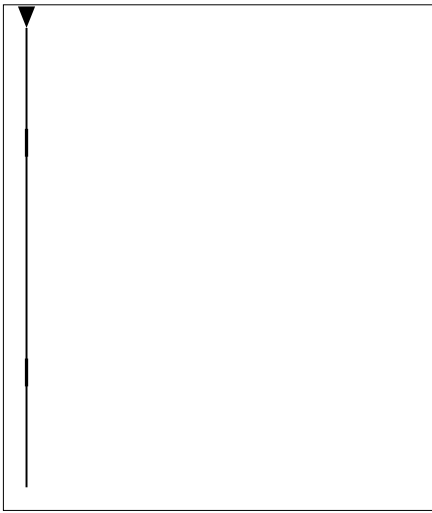

23	Line-No.		Date	27.02.2012	Order-No.		Amount	16	Supplier	
	Path	aserpack/filesW	Author	Yashin A	Height	23.30	Laserpack Fryazino			
	File	b> ECMA_A2420.doc	Customer		Manufacturer	Boehler				
	10/15/18		Line type	Crease	Material	UNIVERSAL-T30				
	Sonstiges		Pointage	2.00	Mat. Table	04	Die-Side			

Rule Processing System ACS 100 for ISO 9000

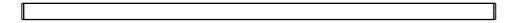
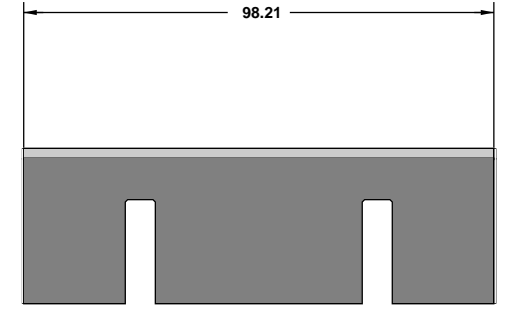

24	Line-No.		Date	27.02.2012	Order-No.		Amount	48	Supplier	
	Path	aserpack/filesW	Author	Yashin A	Height	23.30	Laserpack Fryazino			
	File	b> ECMA_A2420.doc	Customer		Manufacturer	Boehler				
	10/15/18		Line type	Crease	Material	UNIVERSAL-T30				
	Sonstiges		Pointage	2.00	Mat. Table	04	Die-Side			

complete list

Date	File	Order-No.	Author	Customer	Up
27.02.2012	b> ECMA_A2420.dds		Yashin A		1

No.	Line type	Height	Point.	Amount	Bridges		BEMDMARK		KBends		Broaching		Length	Sum	Total	Manufacturer	Mat. Table
					Sing.	Sum	Sing.	Sum	Sing.	Sum	Sing.	Sum					
1	Cut	23.80	2.00		1	7	7	0	0	0	0	0	522.17	522.17		Boehler	04
2	Cut	23.80	2.00		1	6	6	0	0	0	0	0	486.33	486.33		Boehler	04
3	Cut	23.80	2.00		4	2	8	0	0	0	0	2	99.79	399.16		Boehler	04
4	Cut	23.80	2.00		16	4	64	4	64	4	64	2	160.93	2574.88	3982.54	Boehler	04
5	PERFO	23.80	2.00		32	2	64	4	128	4	128	3	85.71	2742.72		Boehler	04
6	PERFO	23.80	2.00		32	2	64	4	128	4	128	3	85.71	2742.72	5485.44	Boehler	04
7	Cut	23.80	2.00		12	1	12	0	0	0	0	0	36.96	443.52		Boehler	04
8	Cut	23.80	2.00		9	1	9	0	0	0	0	0	46.46	418.14		Boehler	04
9	Cut	23.80	2.00		22	1	22	0	0	0	0	0	34.83	766.26		Boehler	04
10	Cut	23.20	2.00		16	2	32	1	16	1	16	2	82.97	1327.52		Boehler	04
11	Cut	23.20	2.00		16	2	32	1	16	1	16	2	82.97	1327.52		Boehler	04
12	Cut	23.80	2.00		8	2	16	4	32	2	16	0	87.38	699.04		Boehler	04
13	Cut	23.80	2.00		48	0	0	1	48	0	0	0	15.65	751.20		Boehler	04
14	Cut	23.80	2.00		2	1	2	0	0	0	0	0	55.25	110.50		Boehler	04
15	Cut	23.80	2.00		4	1	4	0	0	0	0	0	25.92	103.68		Boehler	04
16	Cut	23.80	2.00		2	1	2	0	0	0	0	0	20.75	41.50	5988.88	Boehler	04
17	PERFO	23.80	2.00		16	2	32	0	0	0	0	0	82.99	1327.84	1327.84	Boehler	04
18	Cut	23.80	2.00		16	1	16	2	32	2	32	0	30.95	495.20		Boehler	04
19	Cut	23.80	2.00		16	1	16	2	32	2	32	0	30.95	495.20	990.40	Boehler	04
20	Crease	23.30	2.00		32	2	64	0	0	0	0	0	71.21	2278.72		Boehler	04

complete list

Date	File	Order-No.	Author	Customer	Up
27.02.2012	b> ECMA_A2420.dds		Yashin A		1

No.	Line type	Height	Point.	Amount	Bridges		BEMDMARK		KBends		Broaching		Length	Sum	Total	Manufacturer	Mat. Table
					Sing.	Sum	Sing.	Sum	Sing.	Sum	Sing.	Sum					
21	Crease	23.30	2.00		32	2	64	0	0	0	0	0	57.21	1830.72		Boehler	04
22	Crease	23.30	2.00		64	1	64	0	0	0	0	0	43.22	2766.08		Boehler	04
23	Crease	23.30	2.00		16	2	32	0	0	0	0	0	98.01	1568.16		Boehler	04
24	Crease	23.30	2.00		48	2	96	0	0	0	0	0	98.21	4714.08	13157.76	Boehler	04
					465		728		496		432	296			30932.86		